

LumiLedge K⁸

VERTICAL WALL INSTALLATION DETAIL

U.S. Pat. No 9,062,840 B2

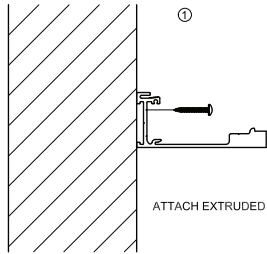

ATTACH EXTRUDED BRACKET TO BLOCKING.

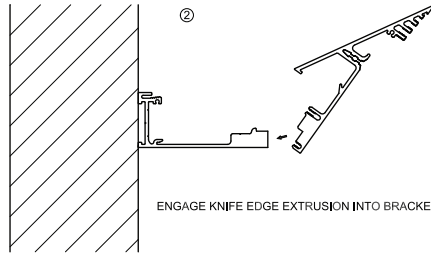

ENGAGE KNIFE EDGE EXTRUSION INTO BRACKET.

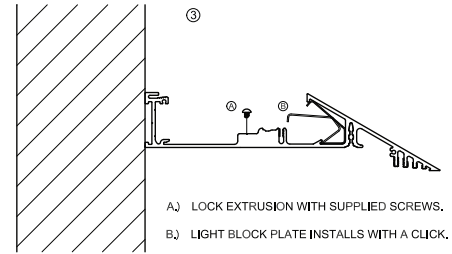

A) LOCK EXTRUSION WITH SUPPLIED SCREWS.
B) LIGHT BLOCK PLATE INSTALLS WITH A CLICK.

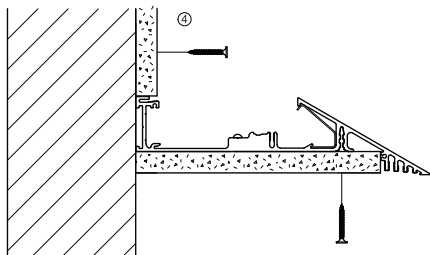

ATTACH 5/8" THICK WALL BOARD TO UNDERSIDE OF EXTRUSION WITH 1.25" DRYWALL SCREWS, THEN ATTACH VERTICAL WALL BOARD ABOVE COVE SYSTEM.

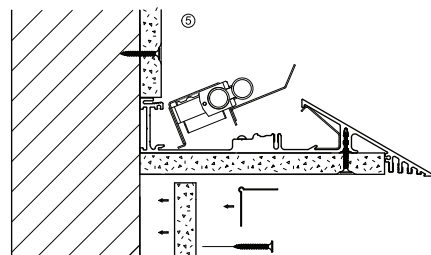

ATTACH VERTICAL WALL BOARD BELOW COVE SYSTEM. INSTALL CORNER BEAD PER ARCHITECT'S SPEC, SKIM COAT JOINTS BETWEEN WALL BOARD AND EXTRUSIONS, INSERT GEAR TRAY INTO FINISHED COVE.

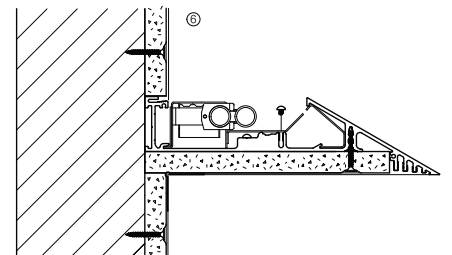

INSTALL SPECIFIED GEAR TRAY AND FASTEN TO EXTRUSION WITH SUPPLIED SCREWS.

FLOATING CEILING INSTALLATION DETAIL

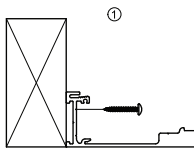

ATTACH EXTRUDED BRACKET TO BLOCKING.

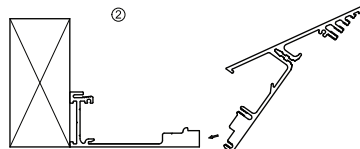

ENGAGE KNIFE EDGE EXTRUSION INTO BRACKET.

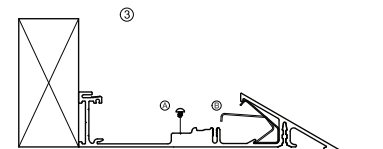

A) LOCK EXTRUSION WITH SUPPLIED SCREWS.
B) LIGHT BLOCK PLATE INSTALLS WITH A CLICK.

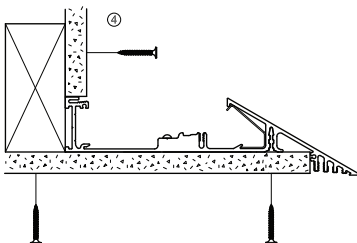

ATTACH 5/8" THICK WALL BOARD TO UNDERSIDE OF EXTRUSION WITH 1.25" DRYWALL SCREWS, THEN ATTACH VERTICAL WALL BOARD ABOVE COVE SYSTEM.

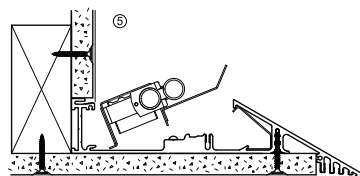

SKIM COAT JOINTS BETWEEN WALL BOARD AND EXTRUSIONS. INSERT GEAR TRAY INTO FINISHED COVE.

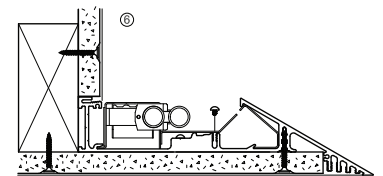

INSTALL SPECIFIED GEAR TRAY AND FASTEN TO EXTRUSION WITH SUPPLIED SCREWS.

