

## READ AND UNDERSTAND THESE INSTRUCTIONS BEFORE INSTALLING

## RECOMMENDED COVE HEIGHT

In order to achieve optimal lighting results, the following cove to ceiling dimensions are recommended. However, please refer to detailed plans as architect specifications take precedence.

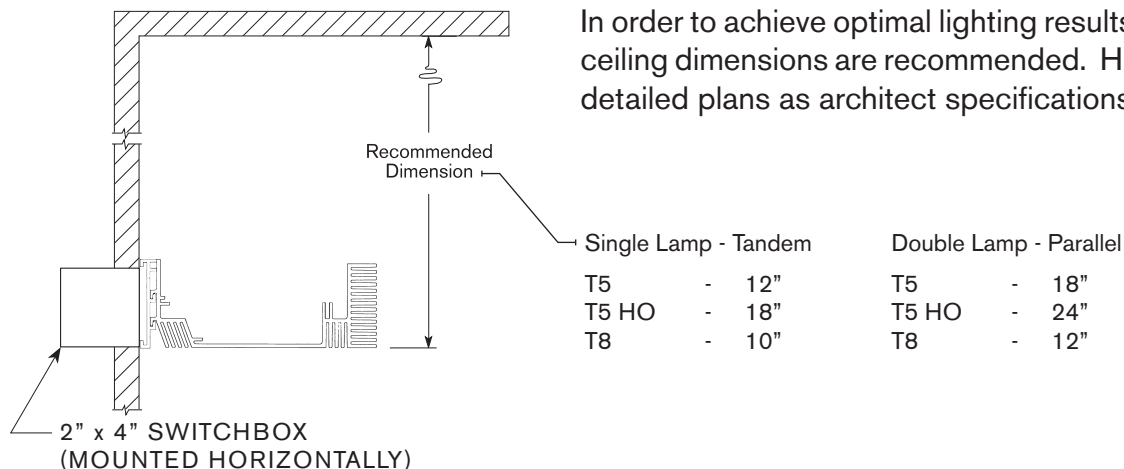

1. Coordinate the location of a 2" x 4" switchbox mounted horizontally with electrician. Snap or laser HORIZONTAL guideline. Align the bottom of the wall extrusion with the switchbox. **(Figure A)**.
2. Mount the first Wall Extrusion and fasten to **ALL** vertical wall studs. **(Figure B)**.

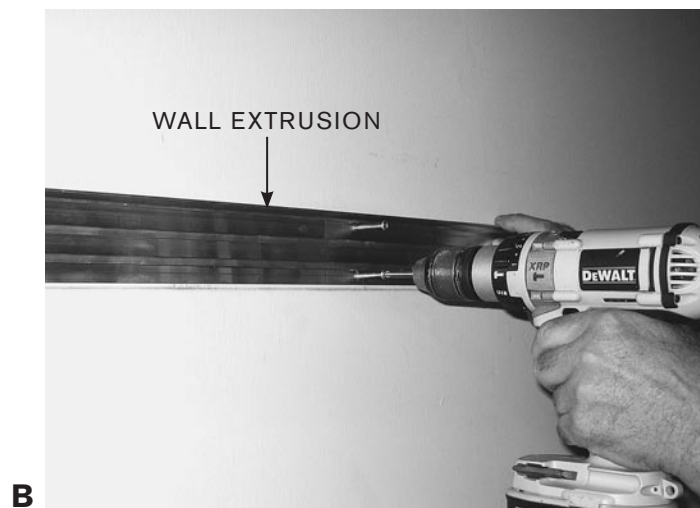
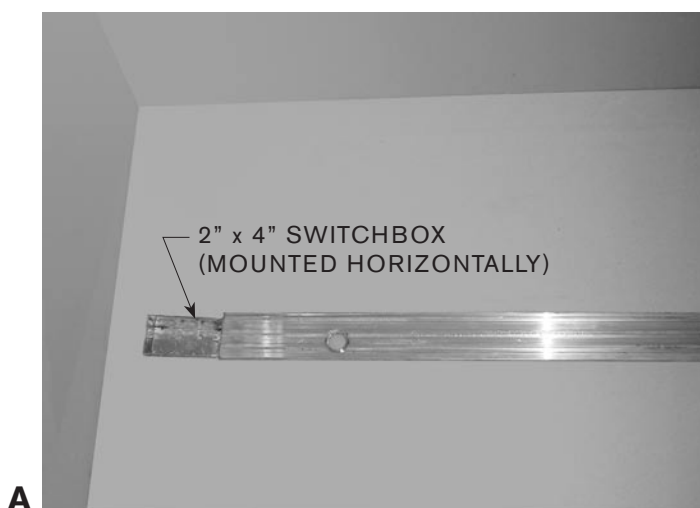

3. Mount each adjacent Wall Extrusion end-to-end by inserting projecting Link Bracket (LB) into the next Wall Extrusion. (Figure C). Secure to ALL vertical wall studs.

4. Confirm that Wall Extrusions are level and fastened securely. (Figure D).

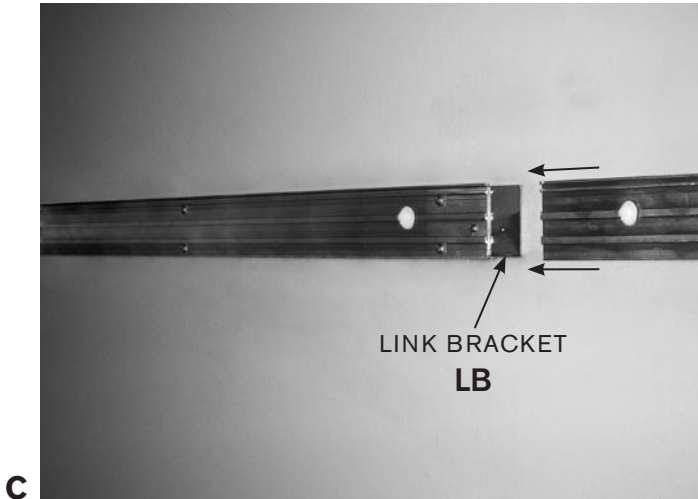

5. Mount first and each subsequent Sheetrock Support Bracket (SSB) by hooking into Wall Extrusion and over Existing Threaded Stud at 24" intervals. (Figure E).

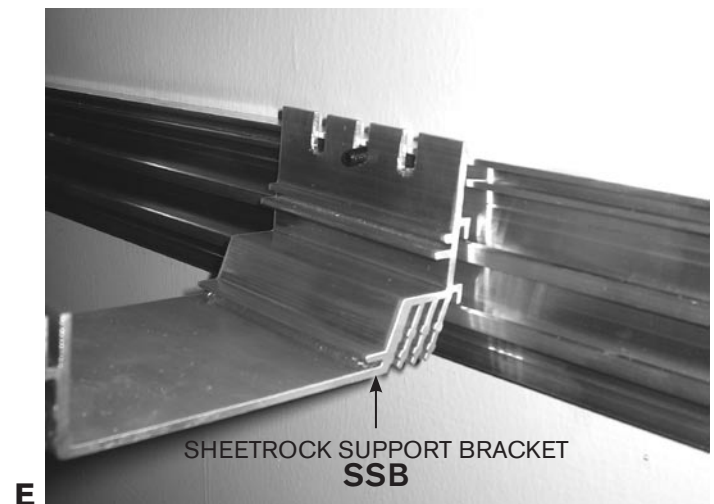

6. Make sure the TWO SSB rails lock in the Wall Extrusion support rails. Secure each SSB with locknut fasteners provided. (Figure F). 3/8" hexhead tool required.



7. Cut Sheetrock (by others) between 6-3/4"–6-7/8" width and apply as Bottom Face. Use the appropriate sheetrock screws (not provided):

- 1" Maximum for 1/2" Sheetrock
- 1-1/4" Maximum for 5/8" Sheetrock

Screw in vertically at front. **(Figure G)**. Screws at rear are slightly angled. **(Figure H)**.

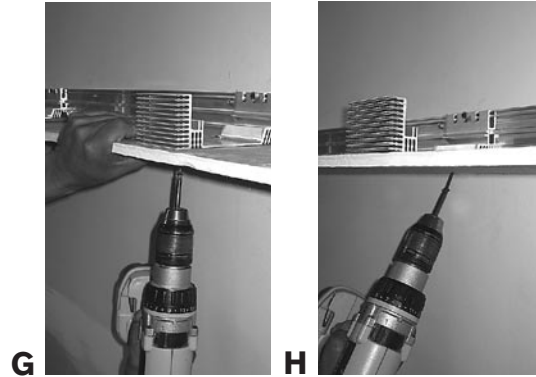

8. Bottom face installed. Ready for front face installation. **(Figure J)**. Note the 1/2" support for the vertical face.

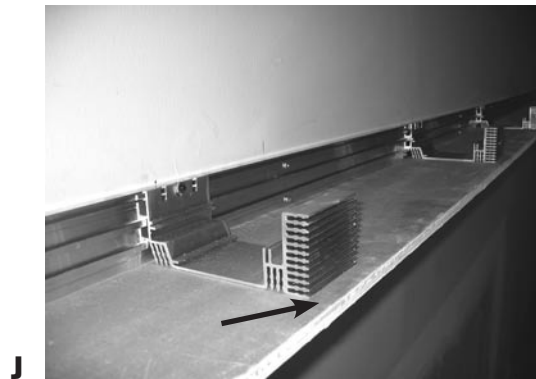

9. Cut and apply Front Face with the appropriate sheetrock screws (not supplied) **(Figure K)**. 2-1/2" recommended face height but may vary. Line of sight issues must be addressed by architect. Note overhang of front face. **(Figure L)**. This ensures clean corner seams. **(Figure M)**.

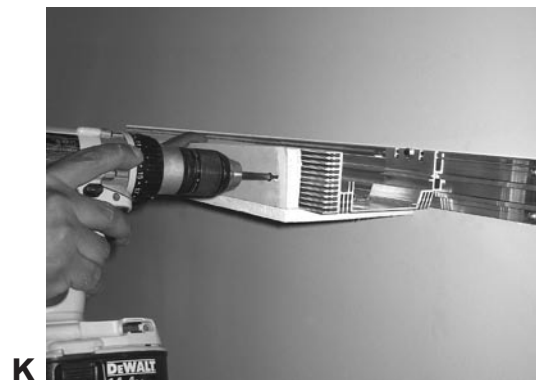

10. Apply Corner Bead and "J" Bead at Top and Bottom Corners. **(Figures L&M)**. Finish inside wall corner with compound and tape (not supplied).



To Finish Coves:

11. The Wall Extrusion (WE) can be field cut to finish any cove run. Move the Sheetrock Support Bracket (SSB) to accommodate the revised length. (Figure N).



Corner Kits available for both Inside and Outside corners.



Alternate Applications

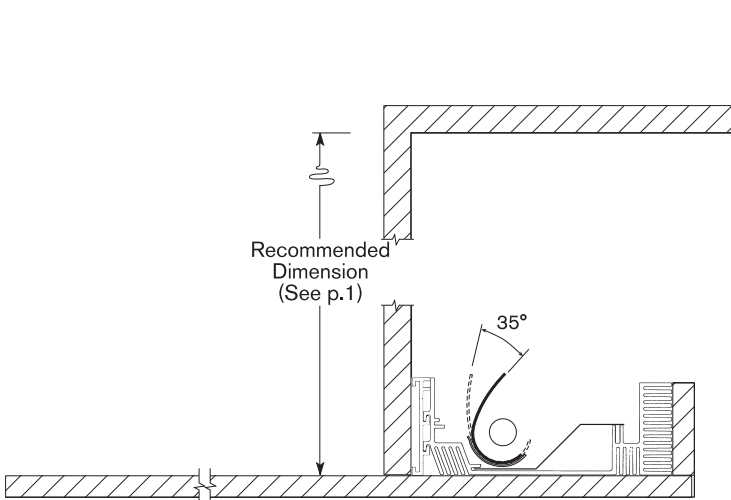

Continuous Ceiling

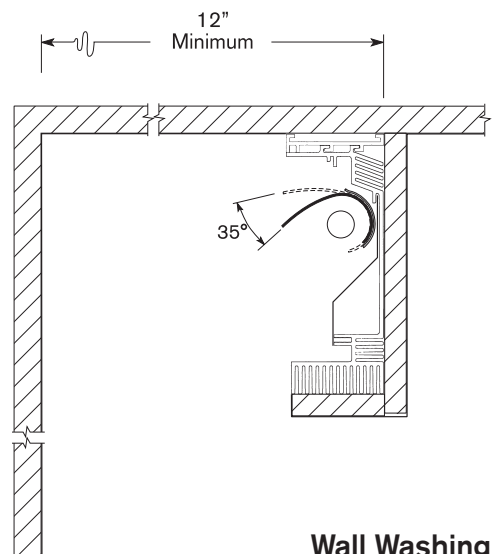

Wall Washing